

Introduction

Thank you for choosing the Elitech refrigerant scale. To use the scale correctly, please read over the manual first, especially the “safety notice”. It is suggested to keep the manual properly with the scale or in a place where you can refer to it conveniently.



Parameters

Max weighing : 100Kg (220Lb)	Operating temperature : -10°C ~ 40°C
Resolution : 5g	Storage temperature : -15°C ~ 50°C
Accuracy : $\pm 0.05\%$ rdg+10g	Temperature fluctuation range : 5°C/h
Power supply : Hand-held device: 5 AAA batteries	Relative humidity : 50-85%
Scale platform : 5 AA batteries	Product size : 271*271*74mm
Battery life : Hand-held device: 50h	Scale platform: 80 h
View and control the scale via mobile APP : Support	

Mobile APP operation

APP operation interface:

0 key: click it to deduct tare and zero out.

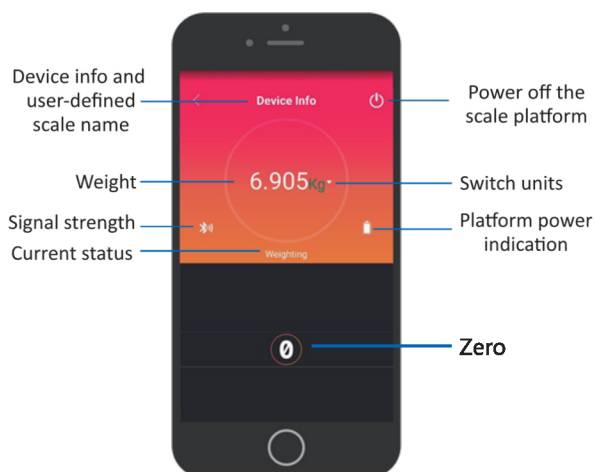

Device list interface:

1. It displays the devices used. To connect with new device, please click “Search” button and enter search interface. The devices that can be connected will show in this interface.
2. Click “User Center” to view user info and other settings.

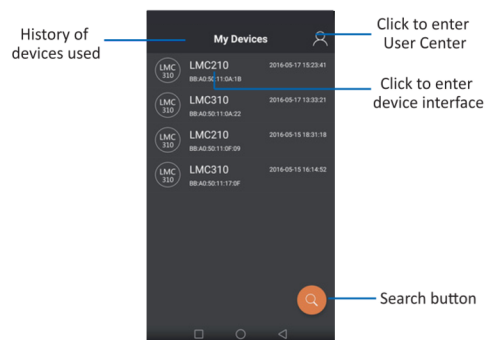

User Center interface

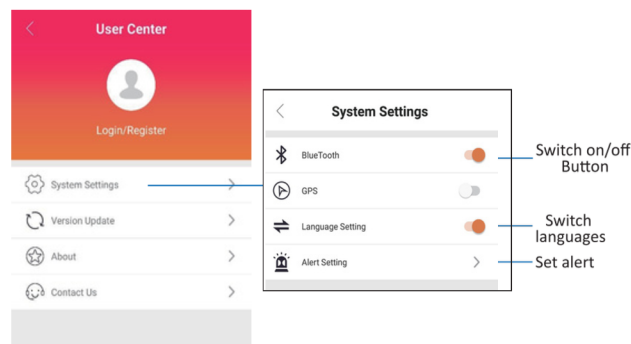

Hand-held device:

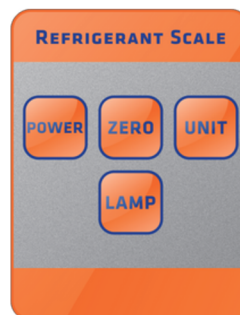
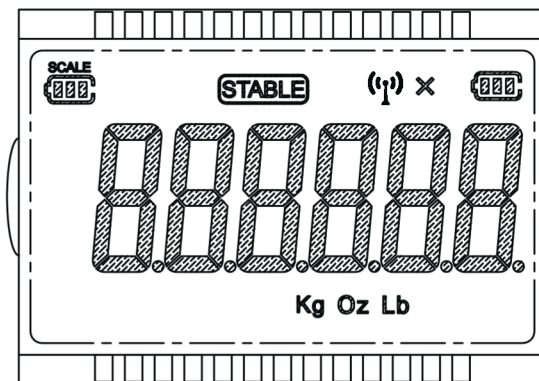

“ ” : Platform power indication
 “ ” : stable weight indication

“X” : Wireless connection status indication

“” : Hand-held device power indication

“POWER”: press to turn on the scale; press and hold for 3s to turn it off.

“ZERO”: Press to zero out current reading on display.

“UNIT”: Press to switch between “Kg”, “Oz” and “Lb”.

“LAMP”: Press to light the backlight and it will last for 10s. Press and hold for 3s to keep the backlight on all the time, buzzer will beep once as indication. Press again to turn off the backlight.

“” : Platform power button; Press it to turn on the scale.

“” : Wireless button; Press it to start Wireless module.

Quick start

1. Install 5 AAA alkaline batteries in the hand-held device.
2. Install 5 AA alkaline batteries in the platform.
3. Place the weighing platform on a firm and level surface, and press on the platform.
4. Press the “POWER” button on the hand-held device.
5. Wait until Wireless signal is connected and is displayed on the screen.
6. Press “UNIT” to select proper unit.
7. Press “ZERO” to deduct tare.
8. Place the object to be weighed until appears stably. Read the LCD.

Functions

Weighing operation:

The scale is designed for total weight of refrigerant tank no more than 100Kg.

1. Take out the scale from the package, place it on firm and level surface, and press on the platform.
2. Press Wireless button on the platform.
3. Take out the hand-held device, press the “POWER” button on the hand-held device until the buzzer beeps once, indicating self-test is completed.
4. Wait until Wireless signal is connected. If yes, the screen displays Wireless icon ; If no, it displays X.
5. Press “UNIT” to switch between “Kg”, “Oz” and “Lb”.
6. Press “ZERO” to deduct tare.
7. Place the refrigerant tank in the center of the scale platform; zero it again to display the weight of refrigerant.
8. Observe the change of refrigerant weight real time during charging and recovery.

Over range indication:

If the weight applied to the weighing platform exceeds the maximum weight (100kg), characters “FULL” will appear on the screen and red LED will flash to indicate alarm.

To prevent damage to the scale and sensor, please do not place objects over 100Kg on the scale platform.

Wireless status indication:

When platform wireless indicator flashes slowly in red, the scale is in sleep mode and not connected to any device. The hand-held screen displays icon X and value “-----”. Press on the platform to awaken wireless device. Platform wireless indicator flashes quickly in red, indicating it is searching device. The indicator flashes slowly in green, indicating device is connected. If 120s elapses, the device is still being searched, the platform and the hand-held device turns off automatically.

Battery level indicator:

The icon on the left top of the screen indicates platform power and on the right top is hand-held device power. The battery power is indicated in segments, which reduce with power consumption until the frame of flashes. Later on, the LCD will become unstable.

Please change batteries before the LCD indicates unstable in case error message affects the normal use of the scale.

Other functions:

1. Power-on self-test: it lasts less than 2s.
2. Zero out full weighing rang
3. The LCD displays numbers from high digit to low digit. The digit that exceeds the digit range will not be displayed.
4. Auto off: If the weight on the platform does not change for 10 minutes, the scale turns off automatically.
5. If 120s elapses, the device is still being searched, the platform and the hand-held device turns off automatically.

Safety notice

1. Please use the scale in specified environment to avoid error or damage of the sensor.
2. Please do not use chemical solvent or corrosive liquid to clean the scale.
3. Please do not disassemble the scale body and inner device; otherwise, it may cause great weighing error.

Remove the batteries if the scale is not to be used for a long time in case the leakage corrodes the scale. The batteries included are not rechargeable. Please do not charge them.

Packing list

LMC-210 refrigerant scale	1 piece
Nylon case	1 piece
AAA alkaline battery	5 pieces
AA alkaline battery	5 pieces
User manual	1 piece



GET IT ON
Google play

Version 4.4 or higher



Available on the
APP Store